



Roxy - Cell  
877-530-3527

Bates R Vee  
I-4 exit 9  
4656 McIntosh Road  
Dover, Florida 33527  
(813) 659-0008

**Sahara**

**SAFARI**



**2000**



## Sahara - *Perfectly Balanced*

Sahara fits a precise 'niche' in your motor home lifestyle. It's the perfect balance of luxury and value, offering many features only found on coaches costing so much more.

Sahara 2000 doesn't skimp on the things you enjoy most. A full galley-thru-bathroom wood plank floor is standard. Hand finished hardwood cabinets throughout the coach interior provide plenty of storage. Upgradeable features include a Bose® Surround Sound system or Fountainhead™ countertops. Sahara makes choosing your next motor home easy - it's the perfect way to balance your lifestyle, and your budget.



Erosia Decor shown



Sahara's luxurious Alder hardwood cabinetry accents a distinctive wood plank floor in the galley and bath-room area.

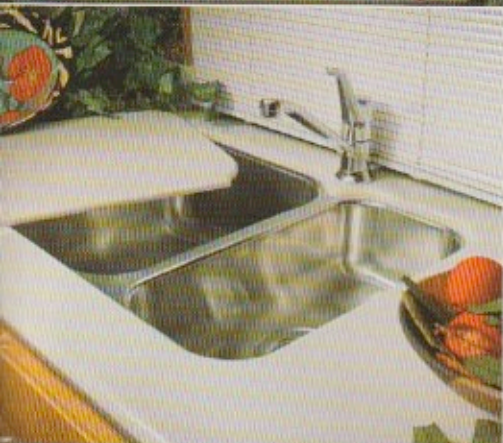

### *Thoughtful livability . . .*

Thoughtful design features make Sahara one of the most 'livable' coaches. With the full galley and living area slide-out expanded, you can 'flip up' extra counter space at the end of the cabinet, a nice feature for the chef at mealtime.

Cover the stainless steel sink with a Fountainhead™ insert for even more counter space. Sahara's dinette is crafted from grain-matched alder and is accented with designer fabric covered chairs. Upholstered valances surround the windows and privacy mini blinds are a snap to use and easy to clean.





## *Slide-out living at it's finest.*

Merely press a button and a new vista in living awaits. Sahara's full galley-living area slide-out operation is smooth and quiet, yet adds so much more room to enjoy.

Sahara's slide-out design places the operating parts within the chassis structure. The single piece fiberglass roof is sloped and pitched for proper drainage. Basement storage moves out with the slide. Ease of operation, superior design . . . another Safari innovation.

Color coordinated wrap-around privacy curtains accent the luxurious decor, highlighted with custom designer fabrics and Berber carpet. Sahara can be ordered with UltraLeather™ cab seats and recliner, as shown, and you have a choice of three color decor packages. The sofa converts to a bed for additional sleeping.

Sahara's custom burl-wood dash panel includes a Delco® AM/FM radio with cassette player and an optional VMS 200EL engine performance monitor.



Sahara's inviting bedroom is tastefully crafted with designer touches that blend coordinated fabrics and hardwood cabinetry. Abundant closet space, 110V lighting and a color TV make the Sahara bedroom a perfect retreat.





The Hurricane Hydronic heating system also provides the Sahara with a continuous supply of hot water, all in a single integrated system. Enjoy the coziest nights in the coldest weather and wake refreshed with a shower with abundant hot water for the whole family.





## Chassis Specifications and Features

Sahara's Magnum Blue Max™ chassis features the Caterpillar 3126B electronic turbo diesel engine for plenty of power. It also makes possible many innovative features.

Other features you'll enjoy include the SoftCruise™ cruise control for freeway driving and the scissor-style sun visors. There is dash air conditioning for your driving pleasure as well as a six-way power driver's seat.

Driving and handling is a breeze with the BFGoodrich Velvet-Ride™ suspension system and four wheel hydraulic anti-lock disc brakes. A PacBrake® engine retarder helps out on the downgrades and the smooth shifting Allison MD3060 World™ transmission makes easy cruising on the rest of the terrain.

When you have reached your destination, the three-point hydraulic leveling system will make your stay as solid as the chassis it's built on.

With a GVWR of 29,000 lbs. and a GCWR of 34,000 lbs., the Sahara can pack plenty of payload.

The famous Magnum 'rack and pinion' slide out has proven to be the most durable in the industry, as well as the most waterproof. Special drainage and bubble gaskets virtually eliminate water and wind noise from the living area.

A large and spacious basement area is heated and insulated to keep your cargo dry and safe from the varying effects of different climates. The basement also provides easy access to all of the coach systems. Deeper lift-up doors make access easy to the pull-out battery tray, the plumbing manifold, engine service center and the Onan™ generator.

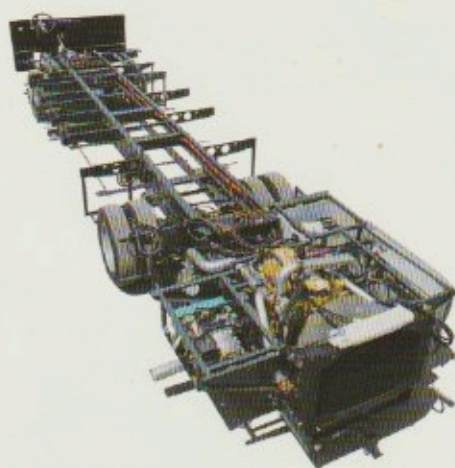

## Sahara 2000 Specifications

Chassis-	Magnum Blue Max™ Chassis
Suspension-	B.F. Goodrich Velvet-Ride™ Suspension
Tires-	255/70R 22.5 Radial Tires
Engine-	Caterpillar 3126B™ Electronic Diesel Engine
Horsepower/Torque-	300HP @ 2,200 rpm, 860 ft-lb @ 1,440 rpm
Transmission-	Allison MD3060 World™ Transmission w/ 6 Speeds and 2 Overdrives
GVWR	29,000 lbs.
GCWR	34,000 lbs.

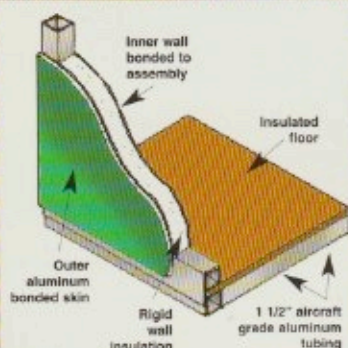

## Single Piece Aluminum Skin

Safari is famous for its aircraft-grade aluminum construction techniques, and the outer skin of each coach is the frosting on the cake, so to speak. This single piece aluminum skin is utilized in a state-of-the-art bonding process that makes leaks virtually impossible. Plus, the lasting durability of aluminum and the beauty of a high gloss automotive grade paint finish will bring years of beauty and trouble-free maintenance.





## Sahara 2000 Features and Options

### Chassis

- 15 Amp Chassis Battery Charger
- Four Wheel Hydraulic Disc Brakes
- PacBrake™ Engine Retarder
- 3-point Hydraulic Leveling System
- Stainless Steel Wheel Liners
- Chassis Service Center
- 5000 lb. Tow Hitch

### Power Systems

- (2) 12V Chassis Batteries
- (4) 12 Volt House Batteries
- Heart Freedom 10™ 1000 Watt Inverter
- 50 Amp Charger
- Monitor Panel
- 20 Watt Solar Panel
- 6.3kw Onan Emerald™ LPG Generator
- 50 Amp Service w/35 Amp Adapter

### Driving Comforts

- SoftCruise™ Cruise Control
- Six-Way Power Driver Seat
- Rear View Camera & Monitor
- Delco® AM/FM Radio w/Cassette Deck
- Dash Air Conditioning/Heat
- Heated Remote-Control Rear View Mirrors w/ Turn Signals
- Scissors Style Sun Visors
- Dash Convenience Center

### Entertainment

- 20" Color Television in Living Area
- 13" Color Television in Bedroom
- Bose® Engineered Surround
- Sound Home Theater System
- Stereo VCR
- Cable TV and Phone Hookup
- Amplified Television Antenna

### Galley Features

- GE® Microwave/Convection Oven
- Two Burner LPG Seaward
- Princess™ Cook Top
- 8 Cu. Ft. Dometic™ Refrigerator
- 120V Fluorescent Lighting
- Fantastic Fan™ in Galley
- Genovese™ Solid Surface
- Countertop w/ Integrated Sink
- Expanding Dinette

### Interior and Bath Features

- Alder Hardwood Cabinetry
- 120 Volt Residential Lighting
- Micro Mini-Blinds Throughout
- Full Wraparound Privacy
- Windshield Drape
- Berber carpet in living room and bedroom
- Wood plank floor extended to dinette
- Large Shower with Skylight
- Jensen Power Vent

### Exterior Features

- Aircraft Grade Aluminum Frame
- Laminated Aluminum Sidewalls
- Molded Fiberglass Front & Rear Caps
- 1 Piece Fiberglass Kemlite Roof
- Full Polystyrene Insulation
- in Roof, Walls and Floors
- Single Pane Windows
- Heated Cargo Storage
- Basement Outlet Center
- Manual Patio Awning
- Full Slide-Out (3006 & 3506 Plans)
- Black Tank Spray System
- Consolidated Plumbing Manifold

### Nomad Package

- Double Panè Windows
- Heart Freedom 20™ 2000 Watt
- Inverter w/ Monitor & 100 Amp Charger
- 75 Watt Solar Panel
- Window Awnings

### Sultan Package

- High Powered Air Horns
- Automatic Step Cover (Front Entry Plans)
- Ice maker
- Delco® 6 Disc Changer/Player
- Bose® Wave Radio in Bedroom

### Sheba Package

- UltraLeather™ 6-way power Cab Seats
- UltraLeather™ Recliner
- Flip-Up Countertop (Slide-Out plans)
- Day/Night Pleated Shades

### Options and Upgrades

- Upgrade to Fountainhead® Countertops
- Add CB radio
- Add VMS200EL™ Engine Monitor
- Exchange to Curved L-Sofa (Replaces Recliner Bar Cabinet)
- Upgrade to Deluxe Dinette Chairs (3006 Front Entry Only)
- Exchange to 10 Cu. Ft. Dometic® Refrigerator
- Add Ventless Washer/Dryer Combo
- Add Digital Satellite System
- Upgrade to Automatic Patio Awning w/ Wind Sensor
- Upgrade to Alloy Wheels
- Add Outside mural on rear of coach

## VMS 200EL™ Dash Monitor

So much information at your fingertips! The bright VMS 200EL dash display allows you to monitor virtually every function of your engine, transmission and chassis. With the push of a button, you can find out your mileage, plan a trip, schedule maintenance,

compare trip performance, and enjoy dozens of other features.

Protect your coach from thieves with the unique anti-theft lockout.

With your special program code, even the key won't start your engine until you say so. Your theft worries are over!



## ED&A "Plug & Play" Harness

Every Sahara has a custom designed "Plug & Play" wiring harness manufactured by



Electronic Design and Assembly, an SMC division. Every harness passes several quality tests prior to installation insuring dependable performance for the life of your coach. Individual wires are printed for easy identification of the circuit they carry.



## SAHARA Floor plans

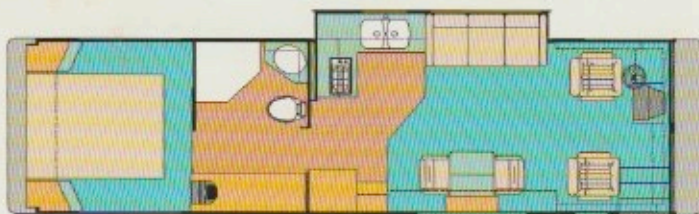

3006 Slide-out  
Center bath - Front entry

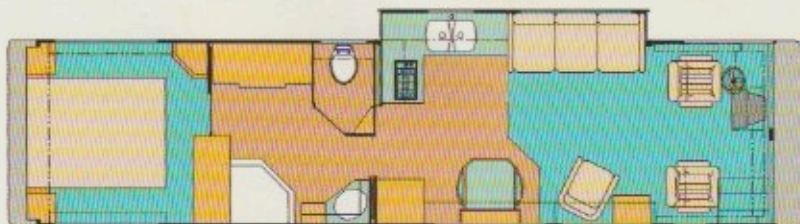

3506 Slide-out  
Private bath - Front entry

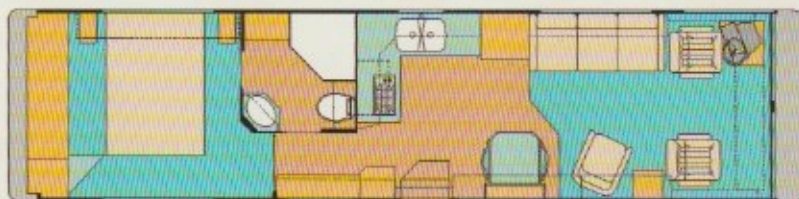

3550 Side aisle  
Front or side entry

All specifications are subject to change without notice or obligation.  
Natural variations in shade, grain and pattern are a characteristic of real hardwood and serve to enhance the beauty of the cabinetry.



  
**SAFARI**  
An  Corporation

**Safari Motor Coaches, Inc.**

Mailing Address: P. O. Box 5639 • Bend, OR 97708  
Street Address: 30725 Diamond Hill Road • Harrisburg, OR 97446

800-458-8735  
[www.safarimotorcoaches.com](http://www.safarimotorcoaches.com)